

Aire

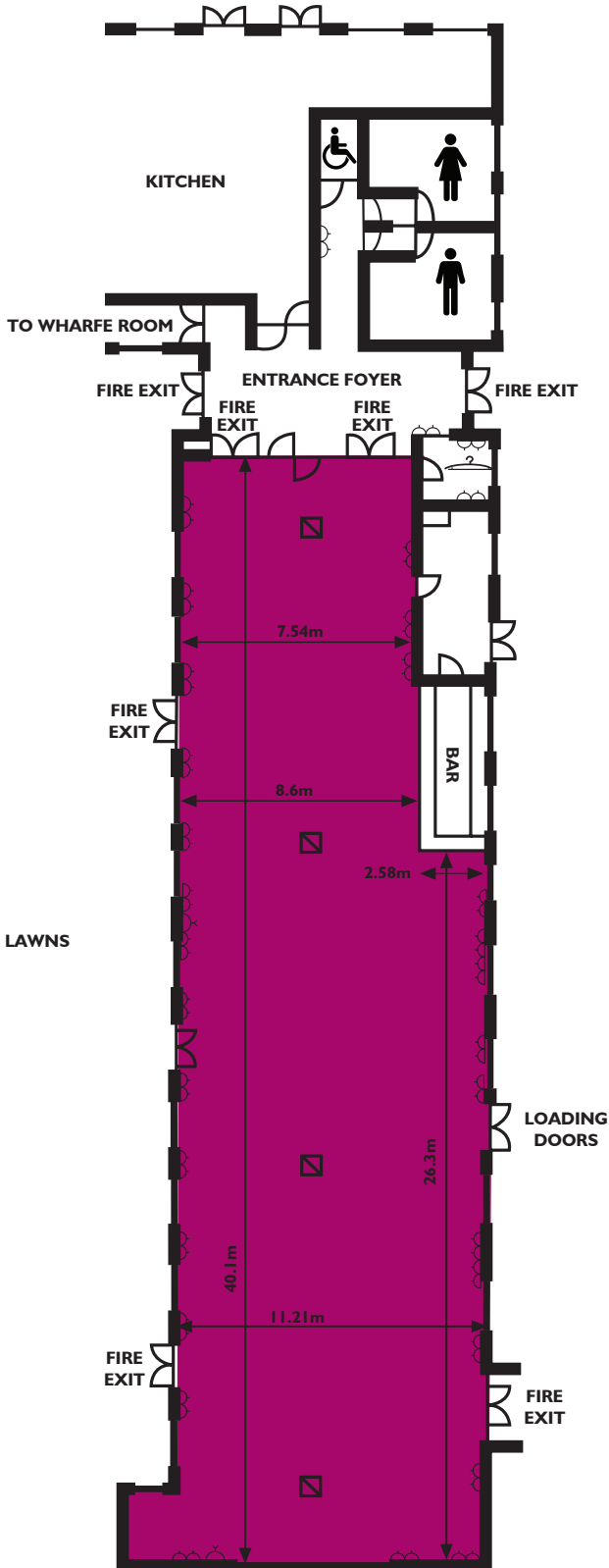
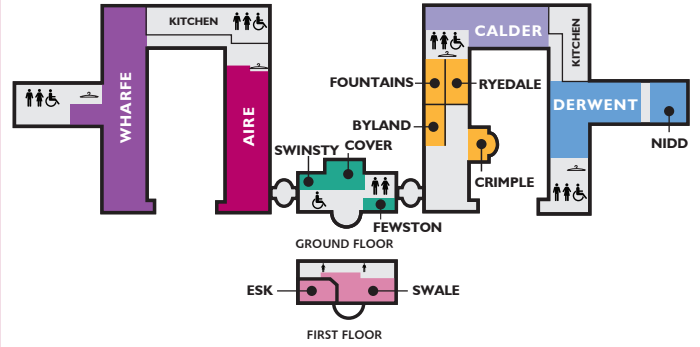

Room Capacities

Layout Style	Number
Theatre	450
Cocktail Reception	500
Lunch/Dinner	220
Dinner & Dance	170
Classroom	120
Boardroom	70
U-Shape	80
Cabaret	144 Tables of 8 170 Tables of 10

Technical Details

- Room Height**
- Floor to Ceiling • 3.1m
- Loading Doors**
- Height • 2.2m - Width 1.49m
- Total Floor Space • 413m²**

- CLOAKROOM
- LADIES' TOILET
- GENTS' TOILET
- DISABLED TOILET
- POWER SOCKET
- TV AERIAL POINT
- OVERHEAD POWER SUPPLY

01423 544544
pavilionsofharrogate.co.uk

