

Calder

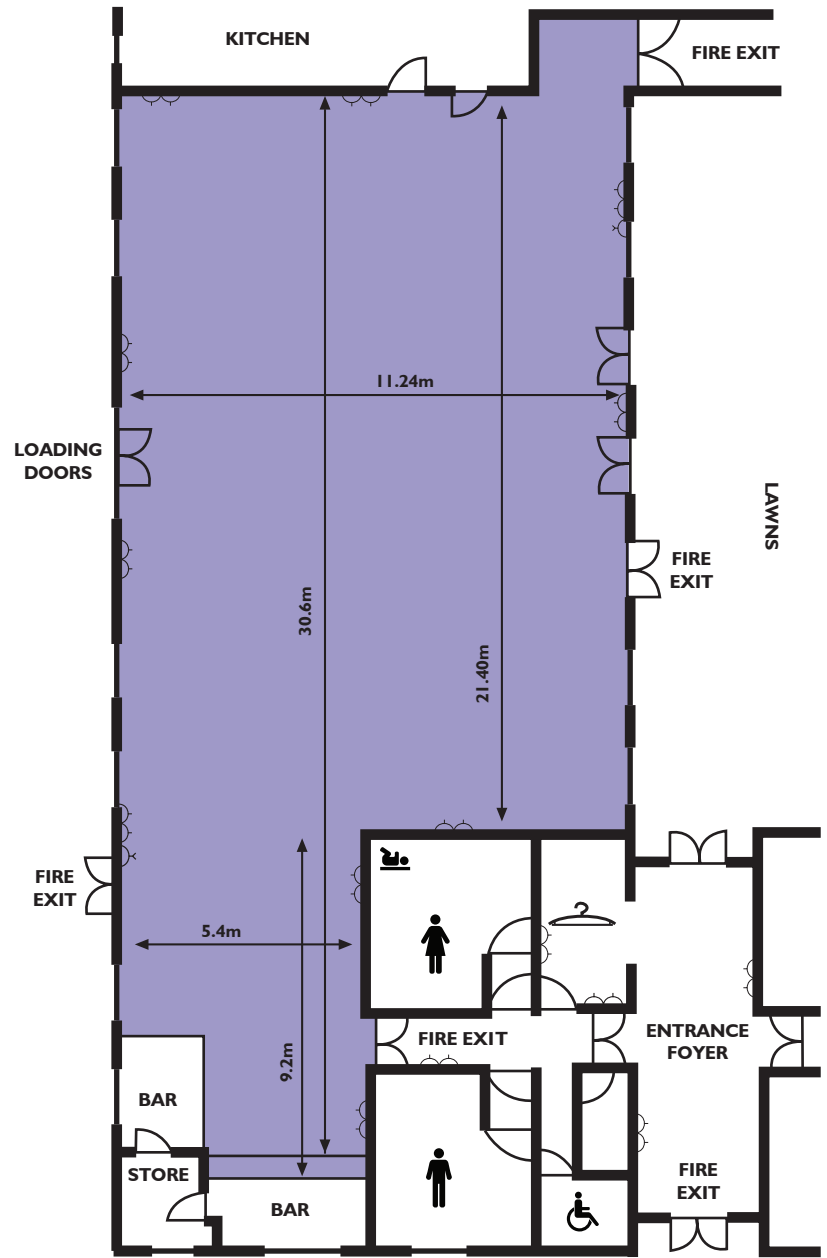
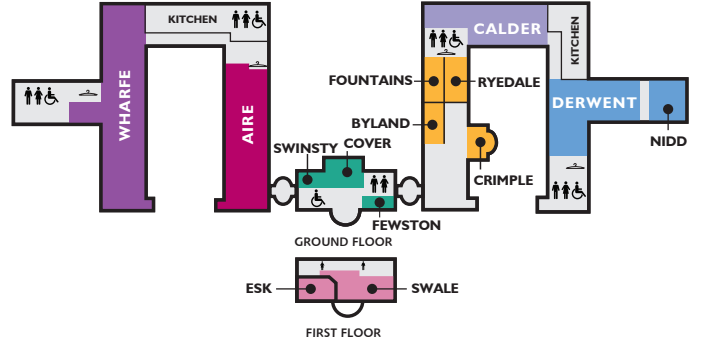

Room Capacities

Layout Style	Number
Theatre	240
Cocktail Reception	300
Lunch/Dinner	140
Dinner & Dance	100
Classroom	90
Boardroom	60
U-Shape	65
Cabaret	120 Tables of 8 150 Tables of 10

Technical Details

- Room Height
- Floor to Ceiling • 3.1m
- Loading Doors
- Height • 2.33m - Width 2.67m
- Total Floor Space • 284m²

- CLOAKROOM
- LADIES' TOILET
- GENTS' TOILET
- DISABLED TOILET
- BABY CHANGE
- POWER SOCKET
- TV AERIAL POINT

01423 544544
pavilionsofharrogate.co.uk

