

Wharfe

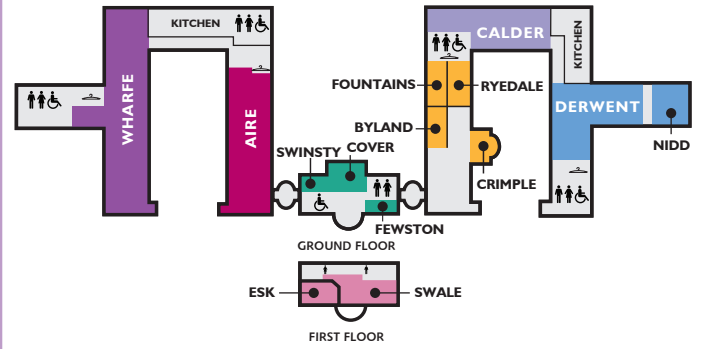

Room Capacities	
Layout Style	Number
Theatre	640
Cocktail Reception	800
Lunch/Dinner	552
Dinner & Dance	468
Classroom	200
Boardroom	120
U-Shape	130
Cabaret	256 Tables of 8 320 Tables of 10

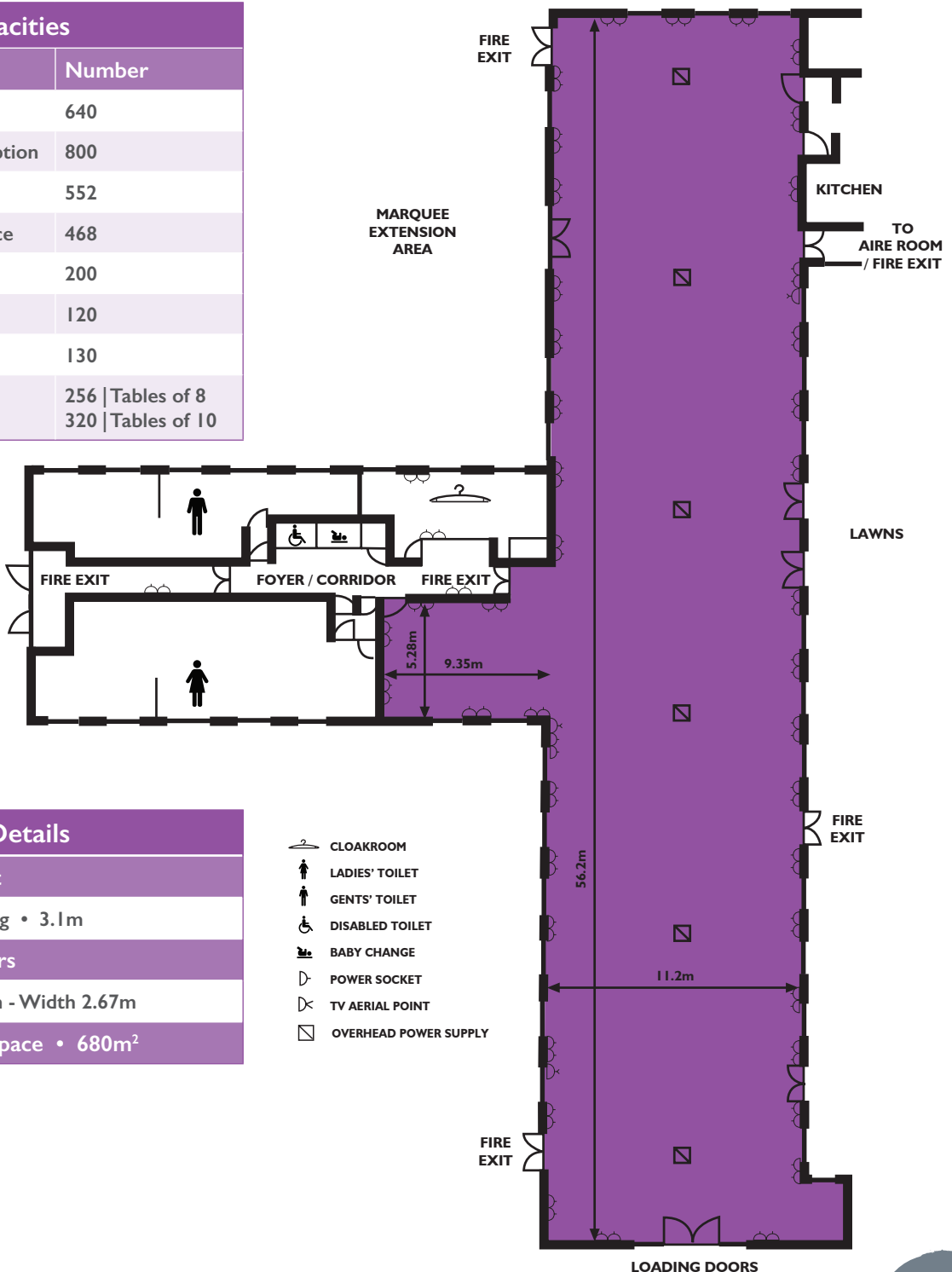

Technical Details
Room Height
Floor to Ceiling • 3.1m
Loading Doors
Height • 2.2m - Width 2.67m
Total Floor Space • 680m ²

- CLOAKROOM
- LADIES' TOILET
- GENTS' TOILET
- DISABLED TOILET
- BABY CHANGE
- POWER SOCKET
- TV AERIAL POINT
- OVERHEAD POWER SUPPLY

01423 544544
pavilionsofharrogate.co.uk

